

Building your vision with our expertise

우리의 전문성으로
여러분의 비전을 구축합니다.



KYONG-HO Engineering & Architects Co.,Ltd.

Contents



Intro

History of Kyong-Ho
Greetings from CEO
Management Ideology
Key Status

Expert

Business Area
Business Field
Water/Environment
Land Development
Transportation
Architecture/Construction Manage-

Vision

Oversea Project
Technology Research
BIM

History Kyongho

A comprehensive consulting firm the lays the foundation for Korea
The way that Kyong-Ho Engineering walked

1990's Our first step and the first way

- 1991** **06** Founded Kyong-Ho Engineering Group Co., Ltd
- 09** Registered as civil engineering management and supervision company
- 1993** **02** Civil engineering construction supervision registration (No. 2-52)
- 06** Licensed as a Principal Agent of Engineering Activity (No. 10-011)
- 1994** **03** Environmental Impact Assessment Agent (No. Seo-44)
- 1995** **03** Registered as a comprehensive professional supervision company
- 07** Corporate research institute (No. 951191)
- 1996** **04** Water control facility company (No. 453)
- 1997** **10** Quality System Certificate (ISO 9001)
- 1998** **02** Designated as an excellent service contractor
- 1999** **02** Designated as an excellent service contractor
- 05** Software Business Registration

2000's Grow into a comprehensive consulting firm

- 2000** **03** Designated as an excellent service contractor
- 12** Changed company name to Kyong-Ho Engineering Co., Ltd.
- 2001** **03** Registered as Disaster Impact Assessment Agency
- 05** Impact Assessment Agency Population Registration
- 2002** **04** Designated as an excellent service contractor
- 2003** **02** Noise and vibration prevention facility company
- 03** Designated as an excellent service contractor
- 2005** **04** Reported total overseas construction
- 10** Awarded Order of Merit of President Industry Award (No. 5447)
- 2007** **07** Registration Agency to establish disaster safety measures
- 2008** **10** Declared as a rural area development consulting company
- 2009** **05** Registration of Industrial design specialized company (No. 02010)
- 05** Registration of specialized firefighting construction provision company

Now preparing for the second leap forward to become the leader of field of construction in Korea

2010's Becoming the leader of field of construction in Korea

2010	07	Registered as evaluation agency
	08	Registered as a safety inspection specialized institution in the field of bridge and tunnel-
2011	02	Registered as a safety inspection specialized institution in the field of repair
	03	Declared as Honest taxpayer (Gyeonggi Province)
	04	Certificate of new renewable energy installation and facilitation specialist company.
	06	Chosen as the company that has excellent culture of labor and management in 2011
2012	03	Seoul Certification of Excellent Execution of Payment of Taxes and Duties)
	04	Established Railway Department
	11	Registered as Safety Inspection Agencies (Architectural)
2013	04	Designated as Excellent Construction Technology Service Business in 2013
2014	03	Seoul Certification of Excellent Execution of Payment of Taxes and Duties
2015	03	Registered Company of Public Sewerage System Control (Public Sewerage System)
2016	06	Business license related to livestock manure – Guri City
2017	07	Registration of Measuring Device Management Agency
	10	Confirmation of Participation in the Work-Life Balance Campaign
2018	01	Registration of an Institution Specializing in Underground Safety Impact Assessment
	05	Design and Construction Business Registration Certificate for Sewage and Wastewater Treatment Water Reuse Facility – Guri City
2019	03	Exemplary Taxpayer Citation – Ministry of Strategy and Finance
	07	Selected as Korea's Best Job Company in 2019
	10	Gyeonggi-do Architectural Culture Award
	12	Construction Industry Specializing in Overseas Construction Industry (Water and Sewerage Facility Construction Project) – International Construction Association of Korea
	12	Construction Industry Specializing in Overseas Construction Industry (The Construction of Steel Bars and Concrete) – International Construction Association of Korea
	12	Family Friendly Certificate – Ministry of Gender Equality and Family
2020	05	Environmental Consulting company Registration – Gyeonggi Province
2021	11	Specialized Institution for Safety Diagnosis of Railway Facility – Gyeonggi Province
2022	08	Selected as Korea's Best Job Company in 2022 – Ministry of Employment and Labor
	12	Family Friendly Certificate – Ministry of Gender Equality and Family
	12	Commendation for Job Creation – Prime Minister of Korea

Greetings

Kyong-Ho Engineering & Architects Co., Ltd. will take the lead with advance technology.

Founded in 1991 with the belief and single-path spirit to lead Korea through technological improvements, Kyong-Ho Engineering & Architects Co., Ltd. is a comprehensive design and management company that provides technological services for infrastructure such as roads, water supply, urban planning, environment, transportation, landscaping, technical diagnosis, safety diagnosis, etc. It is a company, which specializes in comprehensive design, construction project management and maintenance, provides technical services for social overhead capital facilities, which are the driving force of national development.

Based on various experiences and accumulated technical skills of 900 employees including 200 professional engineers, architects and over 20 engineers with Ph.Ds, Kyong-Ho Engineering has performed over 7,000 design and construction projects. Furthermore, Kyong-Ho Engineering, with over 80 registered construction and environmental patents, is leading the development of national land and industry across the country.

The business philosophy of Kyong-Ho Engineering is to contribute to the society by creating an eco-friendly and rich living space. With this philosophy all executive and employees of Kyong-Ho are always focused on creating new technology and best work. It is because of this, Kyong-Ho Engineering is evaluated by client as a trustworthy company

In particular, all executives and employees will continue to work at its utmost for clients and societies with the goal of realizing the public interest through development of top-quality, excellent creative works and

Kyong-Ho Engineering & Architects

Yee-seog Kang

Chairman and Ph.D in Engineering



Management Ideology

Technology Management | Company that has accumulated technologies.

Technology management is a strategy that maximizes the efficiency and performance of management by utilizing technology in a company.

- Seek innovation by improving existing technologies or introducing new technologies.
- Maintain customer confidence and technological competitiveness through quality control.
- Develop professional staff, continually strengthen professional skills and maintain a competitive advantage.
- Through strict project management, we meet the customers' needs and carry out the projects
- We actively utilize information technology to carry out efficient management.

Knowledge Management | a company that constantly researching new technologies

Continuously research new technologies through the process of creating, distributing, utilizing and retaining knowledge, leveraging and retaining knowledge; moreover, innovating to deliver the best results to meet customer needs.

- Operate a specialized technical laboratory to discover and study new technologies and ideas.
- Conduct research and development projects to develop new technologies and discover applicable technologies.
- Spread the culture of knowledge sharing to share knowledge within the organization and share new ideas in their respective specialties.
- Provide training and competency development support to enhance employees' professional skills.
- Actively introduce new technologies to improve existing designs and services, and to launch new designs and services.

Environmental Management | a company that creates an eco-friendly living space.

Environmental management for sustainable development and a healthy life for future generations.

Promote eco-friendly building design

Increase eco-consciousness within the organization by spreading eco-friendly culture.



Technological Innovation

Quality Control

Foster Professional Personnel

Project Management

Utilizing Information Technology



Operation Technology Research Institute

Conduct Research Development Project

Sharing Knowledge

Support Training

Aggressive New Technologies



Eco-friendly building design

Increase Eco-consciousness

Main Status

We recognize human resource management as an important management strategy, and we are currently working hard to develop the capabilities of our employees while hiring new people.

We systematically manage our financial position and establish investment and management strategies to achieve sustainable growth.

Total Number of Employees

901



Licensed Engineers

Completed Projects

696



Professional Engineers

205

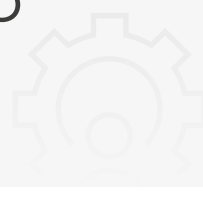

Completed Projects

7109



Summary of Financial Statements

Unit:
hundred million won

Sales

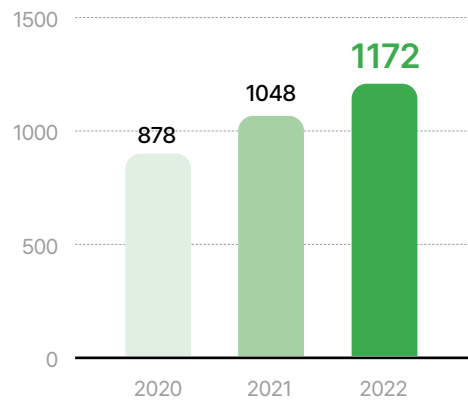

Business Profit

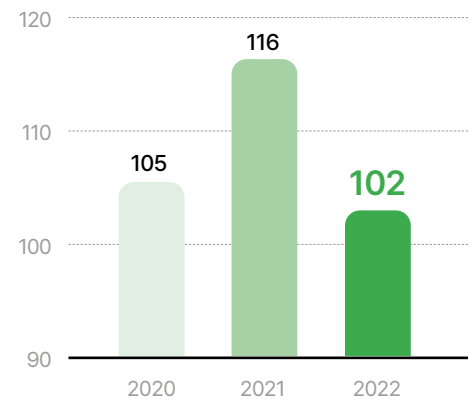

New Projects

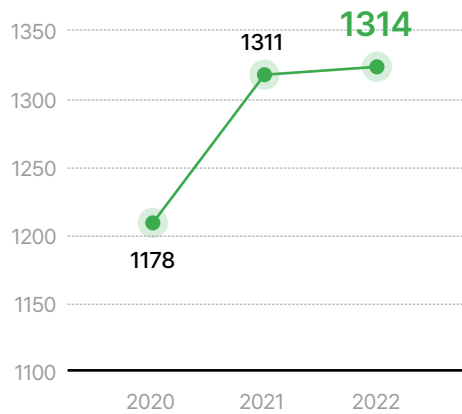

Backlog

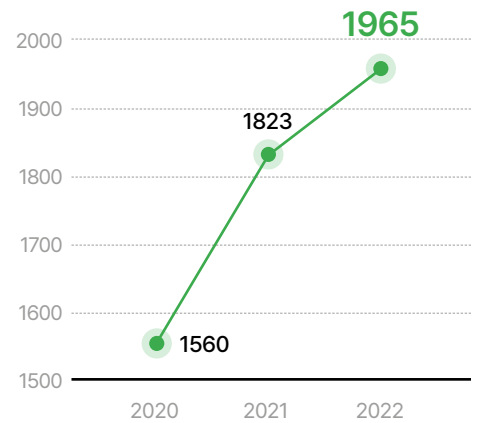

Credit Rating

As of 2022



Corporate credit rating
SCI Evaluation Information



Credit Rating
Credible

BUSINESS AREA

Water Environmental Area

Water and Sewage
Water Resources
Plant and Electric
Environmental
Assessment



Land Development

Urban Planning
Urban
Development
Landscape



Transportation

Road
Railway
Traffic
Structure
Geotechnical



Architecture Construction Management



Vision

Oversea Division
Technical
Research
BIM





WATER

Water and Environmental

Water and Sewage
Water Resources
Plant and Electric
Environmental Assessment

Water and Sewage

Kyong-Ho is a leading water and sewage company in Korea that plans, designs, and supervises water and sewage facilities nationwide by actively participating in various land development projects and installation of water and sewage pipes, water pipes and rainwater pumps..

In accordance with the policy of Ministry of Environment, Kyong-Ho has completed the feasibility study and design of wide-area water and sewage facilities in the country and contributes to improve the water welfare of people. In addition, overseas water supply and sewage development and maintenance projects, such as the Philippines, are successfully carried out. Kyong-Ho is leading the construction of advanced water supply facilities required by the new era

Inchang Rainwater Pumping Station (2008.02 – 2008.07) Guri City Wangsukcheon-ro (331 beonji, Inchang-dong))

1) Basic Design for Rainwater Pumping Station Expansion Project

2) Various licensing documents, etc.

3) On-site Investigation



Name of Project	Project Period	Client
Basic Plan for the Maintenance of Old Water Pipeline (Gyeongsangnam-do)	2020.3~2023.3	Korea Water Resources Co.
Feasibility Study for Namhang River (Third) Water Supply System Adjustment	2022.1~2022.9	Ministry of Environment
Detailed Design for Paltan Gujang Drainage Expansion Project (Second)	2021.5~2022.11	Hwaseong Clear Water Office
Basic Plan for Yecheon Water Supply Maintenance and \Water Purificat...	2020.7~2023.1	Yecheon
Basic Plan (Alternation) for Yangju City Water Maintenance	2020.1~2022.4	Yangju
Detailed Investigation for Pyeongtaek City Old Sewage Pipes Maintenan...	2020.5~2021.5	Pyeongtaek Waterworks Office
Basic and Detailed Design for Naeyang 2 Small Sewage Treatment Facili...	2020.4~2023.1	Yeoju City Sewerage Office
Basic and Detailed Design for Haok and Seonggok Districts Sewerage Mai...	2019.5~2022.6	Geumsan
Basic Plan Nonsan City Water Maintenance Repair(Alteration) Project	2019.5~2021.11	Nonsan
Basic Design and Detailed Desing for Suwolam-ri, Yamak-ri and Samgy...	2017.10~2020.4	Pyeongtaek Waterworks Office
Basic Design and Detailed Design for 723 Banghak-dong Area and One...	2019.3~2020.12	Dobong-gu, Seoul
Basic Design and Detailed Design for Ulsan Area Onsan Water Purificatio...	2018.2~2018.8	Korea Water Resources Co.
Basic Design and Detailed Design for Yangyang Deteriorated Sewage Pip...	2018.3~2019.9	Yangyang
Basic Design and Detailed Design for Pocheon City Local Water Supply Mod...	2020.11~2023.1	Korea Water Resources Co.
Basic Design and Detailed Design for Jeungpyeong-gun Local Water Supp...	2020.7~2022.12	Korea Water Resources Co.
Basic Design and Detailed Design for Gimje City Local Water Supply Mod...	2020.9~2021.10	Korea Water Resources Co.
Basic Design for Inchang Rainwater Pumping Station Expansion Project	2008.2~2008.7	Guri



Basic Plan and Detailed Design for Opo Public Sewage Treatment Facility Expansion Project (2016.12~2021.12)

333-1 Munhyeong-ri, Opo-eup, Gwangju City, Republic of Korea

Opo Expansion (Q=12,000m³/day) Basic Design and Detailed Design for Urban Management Plan 1

Water Resources

Kyong-Ho, Water Resources Division, is responsible for developing water resources such as dams and rivers to control and manage the world's most important water resources, as well as disaster prevention to protect people's lives and property. Major tasks include basic plan for river, comprehensive plan for small river maintenance, river disaster prevention, ecological river restoration, maintenance for water securing, flood control and drainage pumping station planning. Kyong-Ho is constantly striving to be the best in disaster prevention work with the best professionals in each field, such as consultation on water resource development, impact assessment, comprehensive nature disaster reduction plans, small river improvement projects and rainfall reduction measures.

Meanwhile, for overseas projects, Kyong-Ho is demonstrating its capabilities by conducting projects such as feasibility studies for flood prevention and master plan, basic plan and detailed design for flood mitigation measures in West Pampan-



Name of Project	Project Period	Client
Comprehensive Improvement of Storm and Flood Damage Living Area in Ja...	2021.05~2023.01	Danyang
Re-establishment of Comprehensive Plan for Natural Disaster Reduction ...	2019.05~2022.12	Hanam
Redevelopment of Comprehensive Plan for Reducing Storm and Flood Dam...	2018.05~2022.08	Yeoncheon
Basic Plan (Alteration) and River Facility Management Ledger for Dalche...	2014.11~2022.07	Wonju Regional Land Agency
Installation of Rainwater Storage Facility in Shingwan District	2019.06~2022.04	Gongju
Goyang, Changneung Public House District Disaster Impact Assessment	2020.06~2022.03	Korea Land Corporation
Restructuring of Rural Water Utilization System in the Northern Cheonan	2020.08~2021.12	Korea Rural Community Co.
Detailed Design for Dongmyeoncheon River Maintenance Project	2017.07~2021.12	Iksan
Comprehensive Plan (Reorganization) for River Maintenance in Pyeongtaek	2018.06~2021.12	Pyeongtaek
Discontinuation of Disaster Prevention and Maintenance Projects of Seon...	2020.03~2021.12	Seogwipo
Basic Plan and Feasibility Study for Sanboncheon River Ecological Rive...	2019.03~2021.12	Gunpo
Basic Plan and River Facility Management Ledger for Unjeon Daeyacheo...	2020.04~2021.12	Jeollanam
Basic Plan (Alteration) and Detailed Design for Junggricheon River Project	2020.12~2022.06	Icheon
Gamdongcheon River Disaster Recovery Project	2020.11~2021.09	Namwon
Basic Plan (Alteration) and River Facility Management Ledger for Upstream ...	2013.10~2021.01	Busan Regional Land Agency
Eoryong Reservoir and One Other Place Emergency Response Plan (EAP)	2020.03~2020.12	Paju
Comprehensive Maintenance for the Living Area of Jilmae Storm Flood Dam...	2019.06~2020.12	Hapcheon



Comprehensive Maintenance Project for Storm and Flood Damage Living Area in Janglim District in Danyang

(2021.05~2023.01)

- Jukryeongchoen River (Local River) : Embankment L=493m, Channel Maintenance L=1.95km, Bridge 1 Place, etc
- Namjocheon River (Small River : Embankment L=823m, Channel Maintenance L=1.33km, Bridge 1 Place, etc.
- Dangdongcheong River (Small River) : Embankment L=178m, Branched Channel L=269m etc.
- Dooeumcheon River (Small River : Embankment L=345m, Bridge 1 Place, etc
- Goji Drain : L=1.04km
- Pipeline Work : L=149m
- Installation of water gauge, CCTV and automatic prediction warning system

Plant

Kyong-Ho's Plant Division has contributed greatly to the advancement of Korea's environmental infrastructure through actively participating in environmental infrastructure projects such as domestic waste incineration, landfill facilities, household waste treatment and fuelization facilities, recycling sorting facilities, sewage sludge drying facilities and food resource facilities. Furthermore, Plant Division has participated in private investment and overseas projects successfully.

With cutting-edge new technology facilities considering nature and people, we will play the role of environmental engineer, who constantly strives for new concepts of eco-friendly facilities, not abhorrent facilities. As a leader in the field of environmental facilities with the best professional engineers in Korea, we will provide the best quality with thorough design to realize customer service

Feasibility Study and Basic Plan for Dongjak and Gwanak Joint Resource Circulation Center Construction Project(2021.12)

• Recycling Sorting: 190 ton/day • Compression and Reclamation Facilities for Domestic Waste: 260 ton/day • Large-scale Waste Collect: 50 ton/day • Direct Vehicle Parking Lot: More than 99 parking spaces • Site Area: 30,798.00m² • Building Area: 1,720.89m² • Total Floor Area: 39,487.61m²



Name of Project	Project Period	Client
Feasibility Study and Basic Plan for New Construction of Recycling Sorting ...	2020.01~2020.12	Miryang
Basic Design and Detailed Design for Additional Installation of Waste Incin...	2020.05~2022.06	Jangsu
Establishment Revitalization Plan for Residual Site of Siheung Green Center	2020.07~2020.12	Siheung
Feasibility Study for Unsanitary Reclamation Maintenance in Eumseong	2020.07~2020.10	Eumseong
Feasibility Study and Basic Plan for Construction of Joint Resource Circulati...	2020.12~2021.12	Dongjak
Operation Diagnosis for Recycling Screening Center Project	2021.01~2021.04	Ansan
Feasibility Study and Basic Plan for the New Expansion of Recycling Sorting ...	2021.02~2021.08	Chungju
Feasibility Study for Non-Sanitary Landfill Maintenance (2nd) in Junggye-ri	2021.02~2021.06	Hongseong
Detailed Design for Relay Processing and Wastewater Treatment Facilitie...	2021.06~2021.12	Ansan
Feasibility Study and Basic Plan for the Resource Circulation Center Esta...	2021.06~2021.12	Chungju
Basic Design of Recycling Selection Facilities in Gwangju Seo-gu	2021.06~2022.09	Seo-gu, Gwangju
Feasibility and Basic Plan for Food Treatment Facilities in Yanggu-gun	2021.11~2022.11	Yanggu
Implementation and Design of Seongsan Resource Association Facility ...	2022.01~2022.04	Korea Environment Co.
Basic and Implementation Design of Resource Recovery Center Facilitie...	2022.05~2022.10	Seongdong
Basic and Implementation Design of the Environmentally Friendly Ener...	2022.08~2023.03	Jangsu
Basic and Implementation Design for the Expansion of Recycling Select...	2022.09~2023.06	Gapyeong
Feasibility Study and Basic Plan for Construction of Public Pyrolysis Facili...	2022.11~2023.05	Seo-gu, Incheon
Suwon City's Integrated Environmental Permit for Sewage Sludge Treatme...	2022.11~2023.11	Suwon
Implementation and Design of Compression Facility Improvement amo...	2023.01~2023.03	Ansan
Implementation design of replacement of leachate treatment facility (R/O fa...	2023.02~2023.04	Taeon



Basic and Implementation Design of Environmentally Friendly Energy Town in Gimhae (2019.12~2021.12)

Creating an Eco-Friendly Energy Town Using Waste Heat from Incineration Facilities - Neighborhood Work Creating a One and Eco-Friendly Energy Experience Center - Creating a Walkway, Nearby Residential Installation of local recycling bins

ELECTRICITY

New and renewable energy fields such as various land development projects and facilities for expanding industrial infrastructure, construction electricity, and civil engineering. With various experiences and achievements in electricity, water treatment electricity, plant electricity, and complex electricity, professionalism and diversity are evenly distributed. We are successfully engaged in business in many areas through talented people.

Implementation design of Yecheon Stadium lighting tower installation work(2021.12~2022.10)

A lighting tower (night lighting) is installed at Yecheon Stadium to secure illumination necessary for international track and field events, support night games, night practices, various events at night, and travel to summer. Operate the race in a smooth time considering the weather and temperature and humidity of the four seasons.



(tentative name) Design of new electrical, telecommunication, and firefighting construction at Anseong Special School(2023.02~2023.06)



ENVIRONMENTAL EVALUATION

All members of the Environmental Assessment Department are responsible for sustainable development, the role and responsibility of environmental engineers who think about the environment and the future.

→ Environmental policies and environmental planning in various fields such as urban development, industrial complex construction, road and railroad construction, energy, and waste disposal facilities. We contribute to sustainable development through realization and environmentally friendly planning at this development site.

Responding to the climate change crisis.

→ Climate change impact assessment proactively responds to expected risks in the case of projects vulnerable to climate change, and based on this. Reducing greenhouse gas emissions for carbon neutrality and developing climate crisis adaptation plans.

We actively support your Environment, Social, and Governance management.

→ We are fulfilling sustainable development, environmental and social responsibilities through eco-friendly, socially responsible management and transparent management.

→ Environmental Management System Certification (ISO 14001), Greenhouse Gas (ISO 14064), Climate Change Adaptation (ISO 14090), Social Responsibility (ISO 26000), etc. You are using the guidelines in.

Get the edge of technology competitiveness and experience

→ The Environmental Assessment Department has experience and capability advantages over competitors through the implementation of a number of large-scale projects, new areas and large scale. We continue to participate in projects to maintain technological competitiveness.



밀양 생활폐기물 소각시설 대보수사업



전국 고능리 사업장폐기물 최종처리시설

프로젝트명	사업기간	고객사
A Study on the Post-Environmental Impact of Songdo International City Hig...	2023.03~In Progress	Incheon Free Economic Zone Authority
Strategy of Gyoseong Natural Disaster Risk Improvement District and Sma...A	2023.03~In Progress	Boryeong
Study on the Post-Environmental Impact of the New West Maintenance Wi...	2022.08~In Progress	Korea Coast Guard Agency
Gimcheon 1 General Industrial Complex (2nd stage) Post-environmental im...	2022.07~In Progress	Gimcheon
A Small-Scale Environmental Impact Assessment of the Small River Mainte...	2021.05~2021.12	Yangpyeong
Environmental impact assessment of three locations, including Gokgyocheo...	2021.04~In Progress	Geumgang River Basin Envir. Office
Small-scale environmental impact assessment on the installation of medica...	2021.03~In Progress	Jeonil Environment Co., Ltd.
Environmental Impact Assessment of the Construction of Biseulsan Mountai...	2020.07~2021.12	Dalseong
Project of Domestic Waste Incineration Facility in Miryang	2020.07~2023.05	Korea Environment Corporation
Environmental Impact Assessment on Construction work of Gyeongbu Ex...	2020.05~2021.09	National Railroad Corporation
Strategic Environmental Impact Assessment of Railway Construction in Dae...	2020.01~2021.12	Ministry of Land
A Study on the Post-Environmental Impact of Sihwa District Development	2020.02~2022.03	Korea Water Resources Co.
Final disposal facilities for waste from Jeongok Go Neung-ri business site	2019.01~2020.10	Eco Dream Co., Ltd
17-Air-A Regional Environmental Impact Assessment (THAAD)	2017.10~2023.07	Armed Forces Financial Management

Post-environmental impact investigation service for the new western maintenance window project (2022.08~2025.08)
 160,831m²(landed area 50,349m², foundation work dredging volume 178,330m²)







URBAN

National Land Development

Urban Planning
Urban Development
Landscaping

Urban Planning

The Ministry of Urban Planning aims at balanced national land development suitable for regional characteristics and realizing a pleasant and eco-friendly green city. We are carrying out efficient urban planning tasks through flexible operation of the latest technologies. Also, always buy it. We are constantly trying to implement urban space for people.

Master Plan of Silicon Valley in Unified Korea(2017.01~2017.12)

- Location: All of Goyang City
- Area: 268.08km²
- Business Method : Master Plan Stud
- Implementer: Goyang



Establishment of a Basic Plan for Civic Participation in Urban Area



Designation of multi-family housing districts (3rd new city Wangsuk district)(2018.10~2019.12)



Name of Project	Project Period	Divid	Client
2040 Bucheon Urban Master Plan	2018.11 ~ 2023.02	Plan	Bucheon
Basic Plan for Uijeongbu City in 2035	2019.03 ~ 2021.03	Plan	Uijeongbu
Basic Plan for Busan City in 2040	2020.04 ~ 2022.12	Plan	Busan
2035 Basic Plan for Guri City and Urban Management (Reorganization)	2018.02 ~ 2020.12	Plan	Guri
Reorganization of Jindo County Management Plan	2017.08 ~ 2020.12	Plan	Jindo
Investigation and Design of Gyeyang Industrial Complex in Incheon	2020.07 ~ 2022.03	Planning and Design	Korea Industrial Complex Co
National Industrial Complex in National Defense, Chungnam	2017.04 ~ 2018.02	Planning and Design	Chungcheongnam
Designation and Implementation Design of Gapyeong Music Village Urb...	2015.04 ~ 2017.01	Planning and Design	Gapyeong
Master Plan of Silicon Valley in Unified Korea	2017.01 ~ 2017.12	Plan	Goyang
Reorganization of district unit plan outside of urban area	2021.03 ~ 2022.06	Plan	Gwangju , Gyeonggi
District unit plan according to the housing construction in Dojeon-ri	2020.03 ~ 2020.07	Plan	Pureum A&D Architecture
Basic Plan for Urban Residential Environment Improvement in Namyan...	2019.07 ~ 2020.12	Plan	Namyangju
Basic Plan for Urban Residential Environment Improvement in Suwon Ci...	2016.12 ~ 2019.04	Plan	Suwon
Plans to Promote Reorganization of Copper Inchang Handpacks (Change)	2016.11 ~ 2017.12	Plan	Guri
Establishment of maintenance plan and designation of maintenance ar...	2020.03 ~ 2021.03	Plan	Namyangju
Danyang-gun Urban Regeneration Strategic Plan and Revitalization Plan	2019.07 ~ 2021.03	Plan	Danyang
Pocheon City Urban Regeneration Strategy Plan and Revitalization Plan	2015.03 ~ 2017.12	Plan	Pocheon
Comprehensive Development Plan for the Hantan River Area	2019.05 ~ 2020.12	Plan	Pocheon
Determination (change) and implementation plan of the military manag...	2018.11 ~ 2020.11	Plan	Jeollabuk
Feasibility Study Service for Construction of Muan Aviation National Indu...	2021.03 ~ 2023.06	Plan	Muan



Redevelopment (Mokgam 2) Maintenance Project
Maintenance Plan(2022.06)

Statutory City Planning

- To realize the future of Busan Metropolitan City, the second largest city in Korea a number of laws, including the results of establishing a basic urban plan in 2040. Urban planning for urban planning, urban and county management planning, district unit. Have performance and experienced technicians such as planning.

Feasibility Study

- Regional development such as the "Plan for Commercialization of New Businesses in Northern Gyeonggi Province" and others various types of development feasibility including urban development facility decision have experienced technicians and experience.

A Development Project

- A Public Development Project
 - Urban Development Project in Jincheon Seongseok District", 3rd New Town Wangsuk District Public Housing District J, Incheon Gyeyang Industrial Complex, etc. Public development history of urban development, new town, industrial complex, etc. Have business performance and technicians.1
- Private Development Project
 - Pocheon O-dong Urban Development Project", Namyangju O-ri Ilwonju Taek Construction Project", "Establishment of District Unit Plan for Guri O-dong" Private development projects that meet the needs of consumers, etc. are being carried out.

Urban development

The Ministry of Urban Development developed urban development and national land development such as urban development, public housing district development, new city development, and industrial complex development. We are actively participating in the field and contributing to the comprehensive development of the country. Development feasibility analysis, overseas. We will successfully carry out development projects in various fields such as urban development projects, public garages, and solar power generation projects and strive to create a future-oriented city through research and development that fits the paradigm shift of the city.



Basic Plan and Design of Public Housing District in Changneung, Goyang(2020.07-2026.07)

• Area : 7,890,019m² • Customer company : Korea Land & Housing Corporation

Goyang Changneung Public Housing District is the third new city project in the metropolitan area that contributes to the pleasant residential life of the people. of Changneung district planning. The basic direction is to respond to changes in urban development paradigms such as TOD development, housing diversification, industrial structure advancement, and leisure culture change. In addition, the plan reflects the reinforcement of self-sufficiency functions, specialization of historical and cultural contents, and future housing trends in consideration of various housing patterns.

In addition, we have secured a hydrophilic space to revitalize the Changneungcheon Stream community, and a city that creates jobs, a city that creates together, and raising children. Embrace the government's policy objectives for sustainable development, including good cities, eco-friendly cities, and transportation-friendly

Name of Project	Project Period	Client
Architecture Integration Plan for Public Housing District in Beopjo Town, Uijeongbu	2023.02-2029.02	Korea Land and Housing Co.
Research and Design Chungju Anlim Urban Development(replacing method)	2021.09-2027.09	Korea Land and Housing Co.
Implementation Design Zone 1 of Wangsuk Public Housing District in Namyangju	2021.08-2024.08	Korea Land and Housing Co.
Research and Design of Development Project of 20 Industrial Complex 1 in Chungbuk	2021.03-2027.03	Korea Land and Housing Co.
Basic and Implementation Design of Bus Public Garage Construction Project in Centr...	2021.01-2022.07	Pyeongtaek
A Study and Design of Urban Development Project in Top-dong District	2020.06-2021.07	Suwon
A Study and Design of Urban Development Project in Top-dong District	2021.06-2022.04	Doosan Industries Co., Ltd.
Basic Planning and Design of Public Housing District in Changneung, Goyang	2020.07-2026.07	Korea Land and Housing Co.
Basic Planning and Design of Wangsuk Public Housing District in Namyangju	2020.03-2026.03	Korea Land and Housing Co.
Basic Design of Songsan Green City International Theme Park Residential Complex	2019.12-2021.12	Korea Water Resources Co.
Publicly supported private rental housing supply promotion district in Jeonju sta...	2019.06-2025.11	Korea Land and Housing Co.
Research and Design of Public Housing District in Yeonho, Daegu	2019.02-2025.02	Korea Land and Housing Co.
Investigation Design of Public Housing District 2 in Incheon Home	2018.12-2024.12	Korea Land and Housing Co.
Research and Design of Public Housing District in Guri Galmae Station Area	2018.09-2024.09	Korea Land and Housing Co.
Investigation and Design of Urban Development Project in Mokpo 00 District	2017.12-2023.12	Korea Land and Housing Co.
Investigation and Design of Uiwang Chopyeong Enterprise Rental Housing Sup...	2016.05-2019.11	Korea Land and Housing Co.
Research Service for Smart City Business Promotion Strategy in India	2016.05-2018.12	Korea Land and Housing Co.
Service for the establishment of Master Plan for Housing Complex in Cali, Colombia	2015.01-2016.08	Korea Land and Housing Co.
Basic Planning and Implementation Design for Urban Development Projects in Manho	2014.06-2017.12	Pyeongtaek

Basic Plan and Design of Wangsuk Public Housing District in Namyangju (2016.05~2024.08)



LANDSCAPING

It is a cultural act that presents practical solutions to cope with environmental crises, provides a place for communication to form a healthy relationship with the community, and creates land and scenery by applying humanities and scientific knowledge to realize an artistic and creative landscape.

Our company is creating an optimal space for a harmonious life for humans and the environment, including the creation of parks, tourist recreation complexes, and ecological spaces, as well as large-scale national and regional development, ecology, and landscape fields.

Determination (Change) and implementation design service of the Gwongok Cultural Park Park Development Plan(2021.12)

• Cultural Park (264,270m²) - Skywalk, Aqua Stay Ji, Winter Pond, Asan Dive, Asan Story Wall, Management Office (446 m²) etc.

Gwongok Cultural Park is in a location that can serve as the central lungs of Asan City, and the pleasant residential environment of urban residents. Create and create a space for residents' leisure activities, the formation of landmarks in Asan City, and various cultural and cultural activities is a project.

Establishment of a base space for history, culture, and tourism belts connected to Gokgyocheon Stream, Ginkgo Tree Road, and Hyeonchungsa Temple, Skywalk, Media Byeongpung. It is a luxury cultural park representing Asan, including the introduction of various facilities for high-tech cultural platforms such as Aqua Stage.



Name of Project	Project Period	Client
Basic Design and Detailed Design of the Sea Pilgrimage Road of the Envoys Project	2021.09~2022.12	Taeon
Basic Design for the Landscape Improvement at Buyeo Elevation Project	2021.12~2022.11	Buyeo
Basic Design and Detailed Design for the Restoration of Urban Ecological Axis in Jangdong-	2021.04~2022.07	Daejeon
Gokseong Station 1928 Urban Management Plan Decision and Detailed Design Project	2020.12~2022.12	Gokseong
Establishment and Detailed Design of Sports Park in Mojeon-ri, Baeksa-myeon Project	2020.10~2023.02	Icheon
Military Management Plan and Detailed Design for the Farm Bridge Tourist Attraction Cr...	2020.05~2023.01	Jincheon
Basic Design and Detailed Design for the Coal Mine Culture Park Phase 3 Construction	2020.01~2022.03	Gangwonland
2040 Incheon Metropolitan City Park Green Area Basic Plan Reorganization Project	2019.08~2021.12	Incheon
Design of Seomjingang Donghwa Garden and Train Platform Construction Project	2018.07~2021.12	Gokseong
2040 Miryang City Park Green Area Basic Plan (Change) Establishment Project	2019.06~2021.12	Miryang
Basic Design and Detailed Design for Cable Car Construction Project in Ganhyeon Touri...	2019.10~2022.09	Wonju
Determination (change) and Detailed Design of the Gwongok Cultural Park Developme...	2019.06~2021.12	Asan
Yangyang Jukdo Marine Cable Car Basic Design and Feasibility Study Project	2019.10~2020.12	Yangyang
Basic Design and Detailed Design for the Comprehensive Tourism Development Project...	2018.12~2019.12	Wonju
Detailed Design for the Local (Namdo) Garden Construction Project	2018.12~2018.12	담양군

Basic Design and Detailed Design for the Third Stage of the Coal Mine Cultural Park Construction Project(2022.03)



Basic Design and Detailed Design Services for the Restoration of the Urban Ecological Axis in Jangdong, Daedeok-gu (2022.07)





TRANSPORT

TRANSPORT

Road
Railways
Traffic
Structures
Ground

Road

Based on excellent technology, the Ministry of Roads shall conduct feasibility studies, basic plans, basic and implementation of all grades of roads. It carries out design, turnkey design, private business design, and overseas business (road sector), and further environment and human beings. We strive to provide a central and future creative design.



Agricultural and Oedong National Road Construction Project Implementation Design Service(2011.02~2021.02)

• Task contents: L = 4.0km, B = 18.5m (four round trips), design speed 70km/h

The construction of the agricultural and outer-ring national roads on the business route is a section that requires securing trunk functions and a large traffic capacity, and severe traffic congestion. The traffic sharing effect of National Route 7 is excellent, and the Okdong-Farm Road section of the traffic congestion road in the metropolitan area and the replacement of the national road in Gyeongju-si. It is a "National Route Grade I" road that acts as a main highway in local areas in connection with Naenam-Oedong on the bypass road, and the Nongso-Oedong road is a National Route. Increasing traffic volume between Nongso-dong, Buk-gu, Ulsan, and Oedong-eup, Gyeongju-si, Gyeongsangbuk-do among the entire section of Line 7 (Busan to Onseong). The purpose is to resolve the severe traffic congestion due to over-sized traffic and promote balanced development of the national territory.

Name of Project	Project Period	Client
Feasibility Study Service for the Installation of Underground Walkway on the East Side of KTX	2021.11-2022.05	Gwangmyeong
Feasibility Study for the Daesan Dangjin Expressway New Project	2017.06-2019.03	Ministry of Land
Basic Survey for the Dangjin-Asan Section of Dangjin-Cheonan Expressway Project	2018.09-2019.11	Ministry of Land
Basic Design and Detailed Design for Sejong-Pocheon (Sejong-Anseong) Expressway Co...	2017.12-2019.07	Korea Expressway Co.
Detailed Design for the Expansion of Yeongdong Expressway (Ansan-North Suwon) (Section 2)	2017.12-2019.12	Korea Expressway Co.
Basic Design and Detailed Design for Gonam-Changgi (Tool 1) Road Construction Works Project	2019.12-2022.12	Daejeon Regional Land...
Gokseong Seokgok IC-Gyeongmyeon (2nd Section) Road Facility Improvement Construct...	2019.12-2021.12	Iksan Regional Land ...
Basic Design and Detailed Design for the Construction Work of State-Supported Local Road ...	2019.01-2021.12	Busan Regional Land...
Basic Design and Detailed Design for Road Construction in Gwangju-Yangpyeong, Gyeonggi-...	2018.12-2021.12	Seoul Regional Land ...
Detailed Design of the 2nd Gyeongchun National Road (Namyangju-Chuncheon) Road Co...	2023.02-진행중	Wonju Regional Land...
Basic Design and Detailed Design for Bugang Station-Bukdaejeon IC Road Construction (Phase 2)	2021.06-진행중	Complex City Office
Technical Proposal Bid (Proposal) Design and Supplementary Design for the Implementation of Ye...	2021.01-2021.09	Hyundai Engineering
Beobwon-Sangsu, Jori-Beobwon State Map Construction Post-Evaluation Service	2019.05-2020.02	Gyeonggi-do Construction

Hamyang-Ulsan Expressway Construction Project Implementation Design Service (Section 16)(2010.09~2013.12)

• Division of roads - High-speed national highways (Automobile Roads)

• Extension and breadth - Mainline L = 2.8 km, B = 23.4 m (4 lanes), V = 100 km/h - Linear improvement of Central Inland Expressway L = 4.07 km, B = 23.4 m (4 lanes), V = 100 km/h • In and out facilities: Changnyeong Junction (modified clover), Yeongsan Interchange (trumpet) • Bridges (18 locations, L = 2,171m, B = 5.0~54.7m)



RAILWAY

The Railway Business Department was established in 2012 to meet the saturation of road networks and the demands of the times for green transportation. The Railway Business Department is responsible for the development of the entire railway sector, including high-speed, general, urban, light, and magnetic levitation. We will provide comprehensive services through design and supervision. In response to the radical development and change of the railway industry. Green with humans and nature, driving overall technological advances in railway engineering. We will do our best to create a transportation revolution.

Detailed Design for the Basic Design of Construction Work in Section 4 of Gangneung-Jjin Single Line Railway(2021.09.30)

• Extension 22.1 km - earthwork 6.0 km - bridge 3.6 km - tunnel 12.5 km • 3 stations



The construction project of Gangneung-Jajin single-line subway was originally designed to connect Wonsan and Yangyang. The East Sea Line route was closed after the division of the two Koreas, and according to the national transportation network plan. The project was scheduled to be carried out in 2019, but the two Koreas in early 2002. At the meeting, they agreed to connect the North East Sea Line, and in 2018, the inter-Korean government. The East Sea Railway in the "Panmunjeom Declaration" for Peace, Prosperity, and Unification of the Korean Peninsula. The connection has taken shape.

A preliminary feasibility study was conducted in accordance with Article 38(2)4 of the National Finance Act in April 2020. It was exempted and promoted. Currently, the construction of the Jejin-Military Demarcation Line has been completed, and the Gangneung-Jaejin Single-Line Subway Project. Once constructed, it will connect the Wonju-Gangneung and Chuncheon-Sokcho routes to northern Gangwon-do and North Korea.

• Target area: Hyeonnam-myeon, Yangyang-eup, Yangyang-gun, Gangwon-do



Wolgot-Pangyo Double-track Railway Section 3 Roadside Implementation Design Service (2023.04 Scheduled)

• Main line: 2km033.00 • Site: 29,599m² • Structure: Main line arrival BOX, main line ventilation 4 locations • Station: 1 location (Siheung City Hall)

The Wolgot-Pangyo double-track railway construction project includes Seongnam-Yeou Line and Suin Line, the east-west axis of the metropolitan area, according to the determination of the Sinansan Line and the Sosa-Wonsi Line on the north-south axis, the connection of these lines was established. Establishment of an efficient wide-area railway network through Incheon, the southwestern part of the Seoul metropolitan area, and Seongnam area. It is a project being promoted to improve accessibility to the Gwangmyeong Station high-speed railway.

This project is a second project linking Incheon Airport to Gwangmyeong Station on the high-speed railway in the late 1990s. It started with the idea of an airport railway. The first five years of metropolitan transportation in the Seoul metropolitan area Plan (1999-2003) refers for the first time to the second airport railway as a long-term project. Later, Gwangmyeong Station and the metropolitan transportation network plan (2001-2020). The route connecting Bundang was specified as a long-term project.

As such, before 2010, when the preliminary feasibility study was first conducted, this project had two links between the 2nd Airport Railroad (Incheon Airport to Gwangmyeong) and the Seoul Metropolitan Southern Circulation Line (Gwangmyeong to Pangyo) Shinansan Line, which was promoted as a project but was promoted as a north-south axis centered on Gwangmyeong Station. A supplementary plan for the basic plan for the Shinansan Line, which added a branch line to Siheung, in 2009. As it's confirmed, Siheung City Hall Gwangmyeong Station section is shared with Sinansan Line and Wolgot~Siheung. The entire route plan between Wolgot and Pangyo is one by connecting City Hall and Gwangmyeong Station to Pangyo conceived as a business plan.

TRAFFIC

The Ministry of Transportation is responsible for comprehensive transportation plans, public transportation and green transportation, transportation system improvement (TSM), wide-area transportation, traffic impact assessment. The department in charge of overall transportation-related affairs, including traffic safety and the weak, etc., is the best. We are establishing the best transportation system with the best professional manpower in Korea who plans the transportation system. also, in an effort to achieve intelligent transportation systems in the 21st century, ITS, AHS, Smart Highway, etc. It is expanding its design area with advanced road systems and building a human-centered eco-friendly transportation system.



Traffic impact assessment of Gwangmyeong Siheung Advanced R&D Complex (2017.08~2020.09.)



The project to create a high-tech R&D complex in Gwangmyeong-Siheung is planned for the area where large-scale national projects are lifted. In order to prevent reckless development through management and development, it is a development project within a special management area. It is an urban high-tech industrial complex that is promoted and scattered in Siheung-si, Gwangmyeong-Si. It focuses on R&D and smart technologies to drive advancement and technological growth. A key hub of high-tech manufacturing in the southwestern part of the Seoul metropolitan area by creating a high-tech industrial complex.

It is an industrial complex development project under Article 2, No. 9 of the Industrial Location and Development Act with an area of 493,745m², and Article 13-2 (3) of the Enforcement Decree of the Urban Transportation Maintenance Promotion Act Construction of industrial sites and industrial complexes. The area subject to traffic impact assessment of 200,000m² traffic environment survey and analysis accordingly, business sites, and predicting future transportation demand in surrounding areas, problems and improvement measures according to the implementation of the project. Establishment of traffic impact assessment through the process of derivation and implementation plan of traffic improvement measures.

STRUCTURE

Large and Small Turnkey and Alternative Projects for National Infrastructure Expansion, Bridge Structures and Underground Structures Design Participating in supervision and design VE, etc., contributes to strengthening national technological capabilities, economic development, and benefits.

The main tasks include a comprehensive review of overall aspects such as economic feasibility, safety, construction, aesthetics, and maintenance Plan the structures that best meet all conditions and provide the best experience in carrying out numerous projects. Based on technology, the company performs optimal design through the latest equipment and various programs, while at the same time. We continue to develop and utilize new technologies and cultivate human resources through systematic education.

Yeongjong-Cheongna Connection Road (Third Maritime Bridge) Construction Zone 2 (Technical Proposal) (2021.01~2021.09)



Basic Design and Detailed Design for the Installation of the Suspension Bridge at Sireuksa Tourist Site (2018.05~2020.11)



Name of Project	Project Period	Client
Detailed Design for Public Parking Construction in Yangjaecheon Neighborhood Park	2022.01~2022.09	Korea
Detailed Design for Road Facilities Repair in Northern Gyeonggi-do in 2022 Project	2021.09~2022.03	Gyeonggi-do Construction
Basic Design for the Yangpyeong Namhan River Embankment India Extension Project	2022.07~2022.09	Yangpyeong
Detailed Design for the Underground Road Repair in Pyeongnae Project	2022.08~2022.09	Namyangju
Basic Plan and Feasibility Study for the Creation of Cheongmicheon Ecological Explo...	2021.09~2022.08	Yeoju
Implementation and Design Service of Public Parking Lot Construction Project on Py...	2022.02~2023.10	Anyang
Basic Design of the Entrance and Transfer Facilities to Gwangmyeong, Guil Station	2023.02~2023.12	Gwangmyeong
Expansion and Supplementary Design Related to the Construction of a Parking Lot ...	2020.12~2020.12	Korea
Implementation and Detailed Design for the Improvement of Giheung Interchange ...	2015.04~2016.12	Korea Expressway Co.
Basic and Detailed Design for the Construction of Roads Supporting Pyeongchon Ge...	2017.05~2018.11	Daejeon Construction
Implementation and Detailed Design for the Installation of the Bridge in Mukhye...	2021.03~2021.12	Namyangju
Expansion Section Between Hayang and Geumho on National Route 4 (In progress)	2020.11~2023.06	Busan
Detailed Design of the Ecological Axis Restoration Project in Gochang(In progress)	2021.08~2022.07	Gochang Environment
Detailed Design of the Urban Ecological Axis Restoration Project in Gwangjiche...	2021.08~2022.07	Namwon
Cho Seongcheon River Disaster Prevention Project Detailed Design (In Progress)	2021.11~2022.08	Junnam
Basic Design and Detailed Design of Jecheon Fisheries-Cheongpung Road Constru...	2021.11~2022.08	Daejeon
Detailed Design of the 2nd Gyeongchun National Road (Namyangju~Chunc...	2021.11~2022.08	Wonju
Precision Safety Inspection Service at 6 Locations, Including Minrak 3 Bridge on N...	2023.03~2023.09	Uijeongbu Land



Basic Design and Detailed Design for the Construction of Oil Reservoir Public Parking Lot at Gyeongan Drainage Pump Station Project(2018.04~2019.11)



Licensing Service for Infrastructure Installation of Curved District Unit Planning Zone (2018.03~2021.03)



Detailed Design of the Gimpo-Paju Construction Project (Part 2) on National Highway No. 400(2019.05~2019.10)

GEOTECHNICAL ENGINEERING

The Department of Geotechnical Engineering introduces advanced technologies and provides various and abundant. Based on experience, we provide the best geotechnical technical services. The main task is the ground. Investigation and analysis, soft ground design, tunnel and underground space design, slope stability analysis and reinforcement method design, structural foundation. Design work is carried out throughout various ground engineering fields such as earth structure design, and facilities. More stable by conducting an underground safety assessment process, which is the process of evaluating the stability-enhancing impact of surrounding facilities. We're looking for an affordable, affordable design.

Songsan Green City effectively creates large-scale tidal flats created by the construction of Sihwa seawalls while preserving the ecological environment of the area around Sihwa Lake. Sihwa District established in April 2006 to seek rational ways for both nature, environment and human beings to coexist by utilizing. Under the basis of the long-term comprehensive plan, a new type of city that links tourism, leisure, and housing will be created, not only in the Sihwa area but also in the Sihwa area. It is planned to provide a leisure space that can improve the quality of life for the whole nation. Located in the middle of the west coast belt in the Seoul metropolitan area. Based on its locational advantages, Sihwa area is a base area for the west coast belt of the Seoul metropolitan area that supports tourism, leisure and residential functions. Design and construction will be carried out with the aim of fostering.



Name of Project	Project Period	Client
Construction Supervision for the Relocation of National Route 47 in Wangsuk Public Hous...	2023.01~2023.07	Daewoo Engineering
Underground Safety Evaluation Service for the Redevelopment and Maintenance Project ...	2023.01~2025.01	Korea Land ,Gyeonggi
Basic Design and Detailed Design of the Jecheon-Yeongwol Expressway (Phase 1) Project	2022.10~2024.05	Korea Expressway Co.
Detailed Design for the Implementation Design of Dongmyeon-Jincheon (Part 2) Road Co...	2022.10~2023.02	Gyeryong Construction
Technical Proposal Service for the Implementation and Detailed Design of the 1st stage 3 Co...	2022.10~2023.02	HLD & iHalla Co., Ltd.
Bidding Service for the Basic Design Technology Proposal for Ilsan Techno Valley Constructi...	2022.09~2023.02	Daebo Construction
Post-Underground Safety Impact Research Area Among Commercial and Business District D-3 Block	2021.05~2023.09	Jeonglim Architecture
Basic Design and Detailed Design for the Modernization Project of Anak Park in Jinju City	2020.05~2023.03	Jinju
Feasibility Evaluation and Basic Design for the Expansion of Honam Line (Gimje-Samrye) ...	2021.05~2022.11	Korea Expressway Co
Technology Service for the Public Offering of Private Businesses in West Anyang Eco-Frien...	2021.11~2021.12	Mokyang General Architects
Basic Design and Detailed Design for the Sinan-Saengbiyang 2 National Road Construction	2021.03~2021.12	Dohwa Engineering Co., Ltd.
Technology Proposal for the First Construction of Yeongjong-Cheongna Connecting Road	2021.02-2021.08	Geukdong Construction Co., Ltd.
Private Investment Project of Metropolitan Express Railway Line C	2021.02-2021.06	Ministry of Land
Technical Proposal for the Basic Design of Section 1 of the Complex Development of Unde...	2020.07-2020.12	DLENC Co., Ltd.
Technology Proposal for the Implementation Design of Busan Eco Delta City Phase 2 Par...	2019.02-2019.09	Geukdong Construction Co., Ltd.

Technology proposal design/changeable design element of construction of Yeongdong-daero underground space complex development part 1(2020.04~)

• Complex Transfer Center: 137.65m Main Line Tunnel: 3 routes / 80.35m by route (GX-A & C, Wirye Shrine)

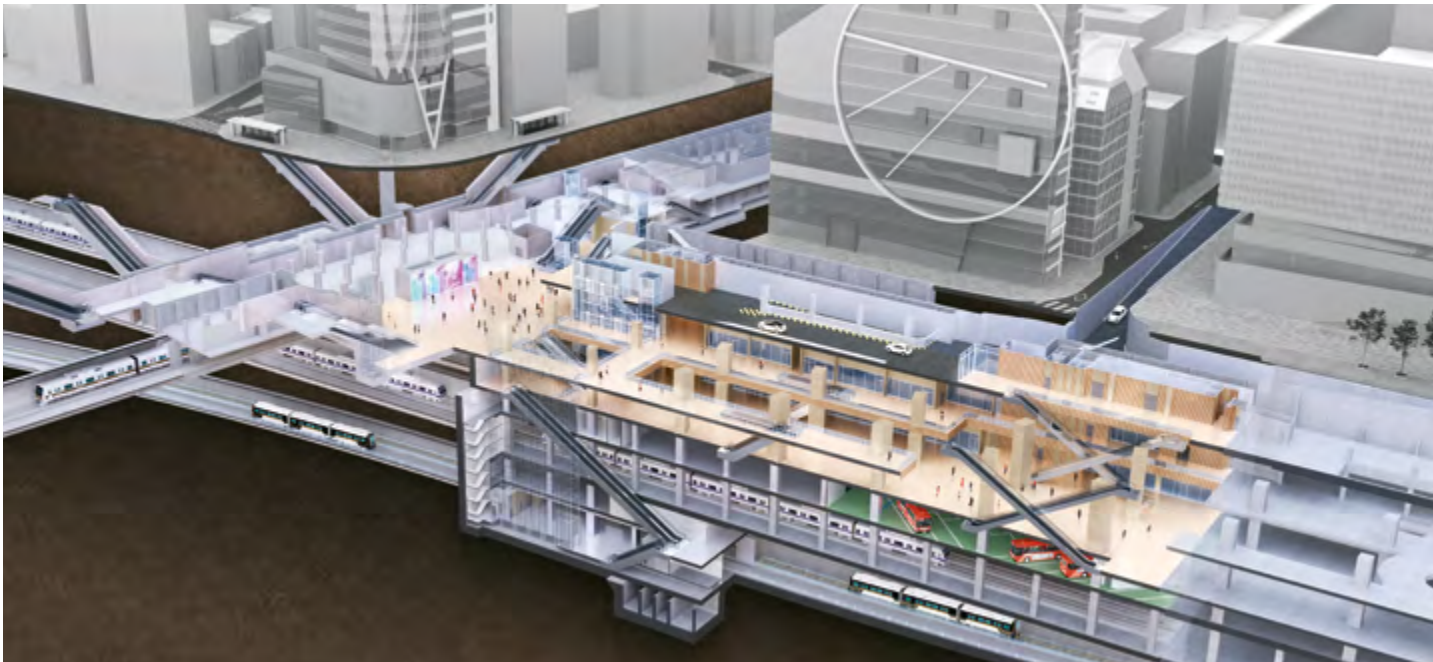

Samseong Station and Yeongdong-daero area are recently international transportation complex in Seoul. In addition to the development plan of Roe and existing subway lines 2 and 9, Samsung-Dongtan, GTX-A, GTX-C (KTX Metropolitan Uijeongbu Extension), Wirye-Sinsa, Southern Metropolitan Express, etc. Large-scale metropolitan railways and regional railways at the level are being planned and promoted, and this task section. The metropolitan express railway, Samseong-Dongtan, GTX-A, C, Wirye Sinsa Line Tunnel, is a railway facility. It is composed of a metropolitan complex transfer center.

Expanding infrastructure such as public transportation system and convenience facilities for citizens in international exchange complex districts. As part of the project, various spaces created in the underground space of Yeongdong-daero. Efficient placement, railroad (Samsung-Dongtan wide-area express railway, metropolitan wide-area express railway GTXA-C, Wirye Sinsa line light rail, subway line 2 Samsung station, line 9 Bongeunsa station) and bus. Building a transit system based on and future using advanced smart technology. We created a public transport hub.



CONSTRUCT /CM

Architecture
Building Business
Management

Architecture
Building business management

Architecture

With accumulated experience and various skills and know-how, we carry out numerous projects, including education, culture, work. All design and design work including various programs such as commercial, residential, local government, government agency, etc. I'm realizing it. From the planning design, accurate communication with the owner and the client is provided for the implementation design. Establish business-related plans step by step, and be creative based on design skills. We will implement high-quality designs and provide optimal design plans.



1 Living Area Transfer Parking Lot

- Location: 536 Eojin-dong, Sejong Special Self-Governing City
- Land area: 6,523.00m²
- Total floor area: 18,192.42m²
- Architectural scale: 4th floor above ground
- Construction rate: 71.45%
- Floor area ratio: 278.89%
- Parking: 568 cars

1 The transfer parking lot in the living area can respond flexibly to the surrounding buildings and Bangchukcheon Stream. It was intended to be designed with a harmonious design. While avoiding unnecessary decorations. Efforts were made to contain the integrity and symbolism of elevation.

Publicity	Space for improving user's practical benefits and parking facilities
Connectivity	Linkage with related plans such as land use status, road traffic planning
Safety	Planning of safe parking space by separating user and vehicle movement
Landscape	Landscape Planning Considering Local History, Culture, and Natural



프로젝트명	사업기간	고객사
Design Contest for Water Resources Satellite Center Construction Project	2023.12~2023.03	Korea Water Resources Co.
Basic Design of the Toegyewon Middle School Playground Public Parking Lot Project	2023.01~2023.06	Namyangju
Basic Design and Detailed Design of Guri Station Transfer Center Project	2022.12~2023.10	Guri
Implementation and Detailed Design of the Iksan Traffic Safety Experience Education Center	2022.11~2023.07	Korea Transportation Safety
Design Contest for Design of Design for the 3rd Stage Project of the Security and Safety Educ...	2022.10~2022.11	Presidential Guard Agency
Basic Design and Detailed Design of Gwangmyeong Traditional Market Second Public Parking	2022.10~2023.06	Gwangmyeong
Construction Supervision of Incheon Family Park (Step 3-2) Project Basic Design and Detailed...	2022.07~2023.08	Incheon Construction HQ
Determination, Basic Design and Detailed Design of Urban Planning Facilities for Public Parking ...	2022.05~2023.01	Namyangju
Construction Design Contest for Ansan Community Complexes Project	2022.05~2022.08	Ansan
Basic and Implementation Design Service for Integrated Parking Lot Construction Project in Cen...	2022.03~2022.09	Gwangyang
Basic Design and Detailed Design for the Complex Facilities in Gamgol Stadium Project	2022.02~2022.10	Ansan
Basic Design and Detailed Design for the Construction of Parking Lot in Civic Sports Square	2022.02~2023.05	Gunpo
Basic Design and Detailed Design of Sihwa MTV Underground Parking Lot Project	2022.01~2023.05	Korea Water Resources Co.
Complementary Design for the New Hangar Construction Project	2022.04~2022.08	Jincheon Forest Aviation
Construction Supervision of the National Institute of Environmental Research's Chemical Prod...	2021.12~2022.07	National Academy of Envi..
Architectural Design Service for the Construction of Parking Building in City Hall	2021.10~2023.08	Yangju
Design Contest for the Construction of Sihwa MTV Underground Parking Lot Project	2021.10~2021.12	Korea Water Resources Co.
Basic Design and Detailed Design of the Eoullim Complex Center in Simgokbon-dong Project	2021.09~2023.06	Bucheon
Detailed Design for the Advanced Fine Dust Surveillance Center Extension of the National Insti...	2021.09~2022.01	National Academy of Envi..
Basic Design and Detailed Design for the Comprehensive Urban Safety Facilities Project	2021.08~2022.12	Eunpyeonggu

Basic Design and Detailed Design for the Transfer Parking Lots in the First Living Area of the Administrative Complex City(2017.01~2018.04)



CONSTRUCTION PROJECT MANAGEMENT

The Construction Project Management Headquarters of the Architectural Environment has been active since the establishment of Kyungho Engineering. As a joint business unit, we have secured excellent performance in various construction fields (apartments, environmental plants, architecture, etc.). It's going out. Excellent quality control and efficient process in accordance with the Construction Technology Promotion Act and other relevant laws. We have a wealth of experience and top professional manpower for management, thorough safety management, and environmental management. We are striving to create the best facilities as well as preventing poor construction.

Jeju Food Waste Biogasization Facility Creation Project(2020.06~2024.02)

- Treatment scale: 340 tons/day • Treatment method: anaerobic digestion method • Architecture: total floor area 11,894.32m² and building area 8,812.23m²
- Other electricity, earthwork, landscape and auxiliary facilities construction type 1



Establishment of food waste treatment facilities for hygienic and stable treatment. Establish a stable treatment system for food waste generated in the province. Abandonment. The water treatment capacity per day is 340 tons, and bio-gasification facilities are also established. Phase production is 41,245 normal cubic meters per day.

After completion, biogas generated during the anaerobic digestion process are used in the facility. Operating expenses worth KRW 2 billion per year by supplying and producing fuel for use as. Look forward to persimmons.



Private Investment Project to Create Yongin Eco Town (BTO-a)(2022.01~2026.03)

• Sewage treatment facilities: Q=12,000//day (civil wood 22,000//day) • Sludge resource facility: Q=220 tons/day • Organic waste resource bio-gasification facility: Q=250 tons/day • Waste water treatment facilities: Q=751m³/day

The private investment project to create an eco-town is 51,000 in Yongin Respia, Pogok-eup, Cheon-gu. Sewage treatment facilities, sludge resource conversion facilities, and organic waste resources underground of 46m² site (Food waste) It is a project to install biogasification facilities, increasing the inflow population. The city has been pushing since 2018 to expand urban infrastructure accordingly. the earth By creating multi-purpose sports facilities and parks together, the living environment of nearby residents and It also seeks to improve the quality of life.

Profit-sharing private investment in which the city and private businesses share losses and profits. It is based on the content of conducting the business in the (BTO-a) method. BTO-a method. Reduce the risk of construction and operation and reduce operating costs and usage fees after completion. The city has been actively promoting it because it is possible.

When the project is completed, Yongin Respia's daily sewage treatment capacity is from 56,000 tons. It will increase by 12,000 tons to 68,000 tons. Also, 220 tons of sludge and 250 tons of sludge be able to dispose of someone's food waste. In particular, residents with various living facilities. The residential environment of the fields has been improved, and food entrusted to private treatment companies has been improved. It is expected to reduce the budget by disposing of waste on its own.

At the same time, the development of the eastern part of the area, including Cheon-gu, which was delayed due to lack of sewage treatment capacity

Business is also expected to gain momentum. "The creation of Yongin-Respia's eco-town" It is an important project to secure the infrastructure of 1.1 million metropolitan cities, he said. "Creating an eco-town." When the project is over, the development of the underdeveloped eastern part of the city and the environment of 1.1 million metropolitan cities. It will greatly contribute to conservation," he predicted.





VISION

VISION

Overseas Business Department
Technical Laboratory
BIM

OVERSEA BUSINESS DEPARTMENT

The Department of Foreign Affairs is increasing the size of official development assistance (ODA) to developing countries every year, and the international community. In line with the changing global environment, such as changes in aid stance and expansion of global infrastructure markets, overseas. I am continuously participating in various projects.

With the expertise and technology, we have, we have the Philippines, India, South America, Myanmar, Pakistan, It is carrying out and participating in projects ordered by Colombia and other countries, especially domestic achievements International development with the Korea Exim Bank (KOICA) and the Korea International Cooperation Agency (KOICA), which are funding organizations. It is provided by banks such as the World Bank and the Asian Development Bank. Participating in the loan projects, various types of projects such as roads, bridges, urban development, water resource development, water supply, etc. We're working on projects.



Feasibility Study

- The new Mancantian bridge to be built on the Pasig Potrero River is technological, Environmental, social, and economic surveys and surveys.
- Flood control facilities (beams, floor protection, etc.) in Porac City, Pampanga Investigation required for

Detailed Design

- Detailed Design of the New Mancantian Bridge to Be Built on the Pasig Potrero River
 - Length: L=340.0m
 - Number of lanes: 4 lanes
 - type of bridge: Cable Stayed Bridge : Cable Stayed
- Flood Control Facilities (Beams, Floor Protection, etc.) in Porac City, Pampanga Investigation Required for Installation
- Design of Roads and Bridges and Detailed Design of Underground Drainage Channels in Macabebe City
- Detailed Design of Hydrological Watertgate in Cut-off Channel in Masantol City

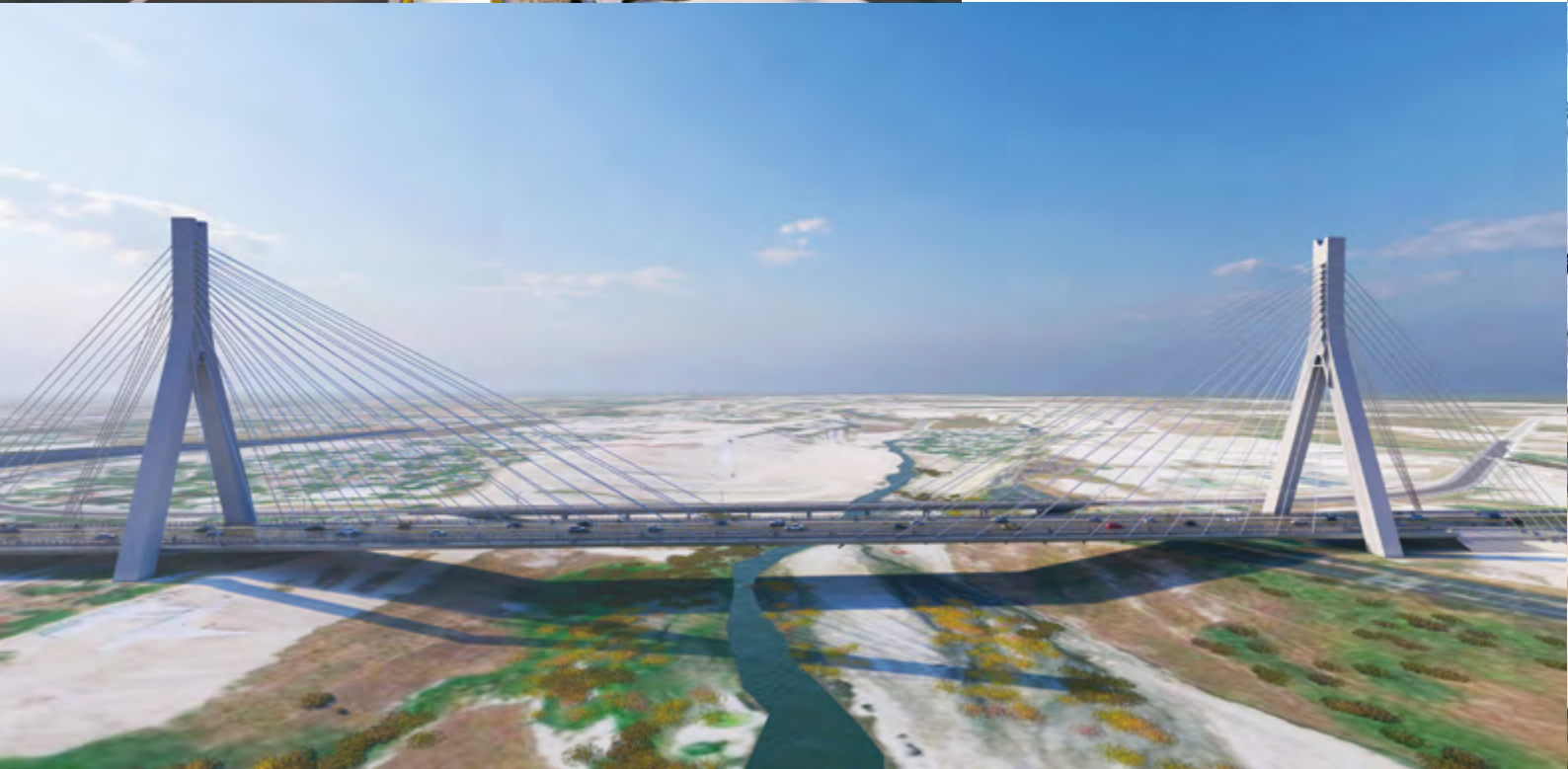

BIM

Converged with BIM, drones, Internet of Things, big data, artificial intelligence, and virtual reality in the wave of the 4th Industrial Revolution Dedicated to Digital Transformation based on Cyber Physical System (CPS). It has departments and professionals and integrates innovative technologies into the design field to implement smart construction technologies. I'm trying to lead the way.

Basic Design and Detailed Design of Dangjin-Asan Expressway Construction (Section 1) (2021.02~2022.09)

Location: Songak-eup-Sinpyeong-myeon, Dangjin-si, Chungcheongnam-do Order: Korea Expressway Corporation Task Details: Front-BIM Design



TECHNICAL LABORATORY

In the era of internationalization and openness, our technology research institute aims to develop into a global leading company. It was established for the purpose of specialization, specialization, and efficiency through technology development.

Technology in the fields of construction, civil engineering, environment, and plants through the implementation of national R&D projects, new technologies and patent development, etc. By developing, we will contribute to the development of the country by upgrading the national infrastructure and reducing costs.

NEW TECHNOLOGY

Technology Name	No.
An Uneven Formwork and Waterproofing Method of PE-Panel	New Technology No. 80
Method of Sampling Lower Sediment Using Cylindrical Open/Close Sampler	New Technology No. 100
Reclamation waste sorting device using a two-stage reverse rotation screen separator	New Technology No. 161
Sewage Advanced Treatment Technology (KHBNR) using anaerobic, oxygen-free, aerobic and dissolved oxygen reduction tanks	New Technology No. 36
New Sewage Advanced Treatment Technology (KHBNR) Environmental Technology Verification using narrow air, oxygen-free air, and dissolved oxygen reduction tanks	New Technology No. 38
Ozone Demand Continuous Measurement and Ozone Process Automatic Control System	New Technology No.1472
Sewage elevation treatment technology using aerobic tank and dissolved oxygen reduction tank of conveyance sludge	New Technology No.303
Operation Efficiency Technology of Advanced Water Treatment Facilities through Re-	New Technology No.605
Automatically controlling the amount of ozone injected by net ozone consumption (Kct) in advanced water treatment plants	New Technology No.384
Precast Concrete Floor Plate Method for Bridge Using Reinforcing Ribs, Hunchs, and Corrugated Steel Wire Shear Connections (Rib-Deck Method)	New Technology No.751



PATENT

Content	Registration No
EARTH WALL PLATE OF SLOPE PROTECTIVE STRUCTURE AND ITS CONSTRUCTION MET	Patent No.086463
Patent of Synthetic Resin Formwork Panel	Patent No.087984
Patents for Slope Grass Germination Boosters	Patent No.089520
Multi-Stage Direct Heating Type Low-Pollution Rotary Kiln	Patent No.128985
Sliding Repair Method for Slope	Patent No.153498
Construction Method of Watertight Concrete Structures Using Synthetic Resin Panel with Iron Side	Patent No.0194071
Construction Method of Watertight Concrete Structures Using Panels Used as Inner Construction	Patent No.0218175
Intermittent Batch Class by Automatically Measuring Non-Oxidizing Ratio and Nitric Acid Nitrogen in Real Time in Biological Wastewater Treatment Process Method and Apparatus for	Patent No.0247321
Construction Method of Waterproof Sheet	Patent No.0248484
Sorting Device for Heavy and Light Materials Buried in Landfill	Patent No.0250854
A Sediment Sample Collection System for Rivers and Lakeside Floors	Patent No.0269885
SORTING DEVICE FOR WASTE-FILLED SOIL	Patent No.0273840
Local Excavation Prevention Device for the Lower Phase of the Circular Bridge Using Discs	Patent No.0308743
Leakage Prevention Method of Water Tank Drain Pipe Penetration	Patent No.0339919
APPARATUS FOR HEAT FUSING POLYETHYLENE PANEL JOINT	Patent No.0351614
Rebar Jointing Device	Patent No.0355494
Wastewater Treatment Apparatus and Method	Patent No.0365448
Tree Protection Support Frame and Tree Protection Method Using Permeable Concrete	Patent No.0365449
Automatic Control Device and Method for Ozone Process and Advanced Oxidation Process...	Patent No.0373511
Automatic Control Device and Method for Ozone Process and Advanced Oxidation Proces...	Patent No.0373512
Automatic Control Device and Method for Ozone Process and Advanced Oxidation Proces...	Patent No.0373513
Construction of Arch-shaped Structures in Subway and Community Areas with Constructi...	Patent No.0390369
Wastewater Purification System	Patent No.0394997
Internal Flow Rate Control System for Wastewater Treatment System	Patent No.0434639
FLAT MOBILE HOT AIR DRYING FURNACE	Patent No.0438250
Air Inhalation Device on the Street of Urban Areas and Air Inhalation Method	Patent No.0464187
Blocking Shelf Structure with Air Pressure Discharge	Patent No.0464188
Atmospheric Diffusion Device on Urban Streets and Air Diffusion Method Using It	Patent No.0464188
FLUIDIZED MELTING STOCA INCINERATOR	Patent No.0492742
Wind Drop Prevention and Indoor Ventilation in High-Rise Buildings	Patent No.0529218
A Road with a Double Windproof Structure	Patent No.10-0655464
Prefabricated Lightweight Synthetic Resin Coating Plate	Patent No.10-0659969
Prefabricated Lightweight Perforated Plate	Patent No.10-0673415



KYONG-HO Engineering & Architects Co.,Ltd.

Head Office

(11940)
Kyong-Ho Building,
41 Cheyukgwang-ro
74Beongil, Guri-si,
Gyeonggi-do

T. 031-553-0040
F. 031-564-5844

Songpa Office

(05702)
Kyong-Ho Building,
209 Jungdae-ro
Songpa-gu,
Seoul

T. 02-401-7947
F. 02-401-7949

Songpa Branch Annex

(05702)
Dongwon Building,
213 Jungdae-ro
Songpa-gu,
Seoul

T. 02-2180-2501
F. 02-2180-2520